



BirdFlex

USER MANUAL

BirdFlex

USER MANUAL



Please read this manual very carefully before using the product. The manual contains important instructions for the safe use and longevity of your bike.

If you need any type of support or warranty information for your BirdBike, please contact us before returning it back to wherever you purchased it. The BirdBike Support Team is ready to help you via phone or email and you can also visit support.bird.co for more info.

Phone: 1-888-309-3702 (M-F 9a-5p EST)

Email: BirdFlex@bird.co

Web: support.bird.co

BirdFlex

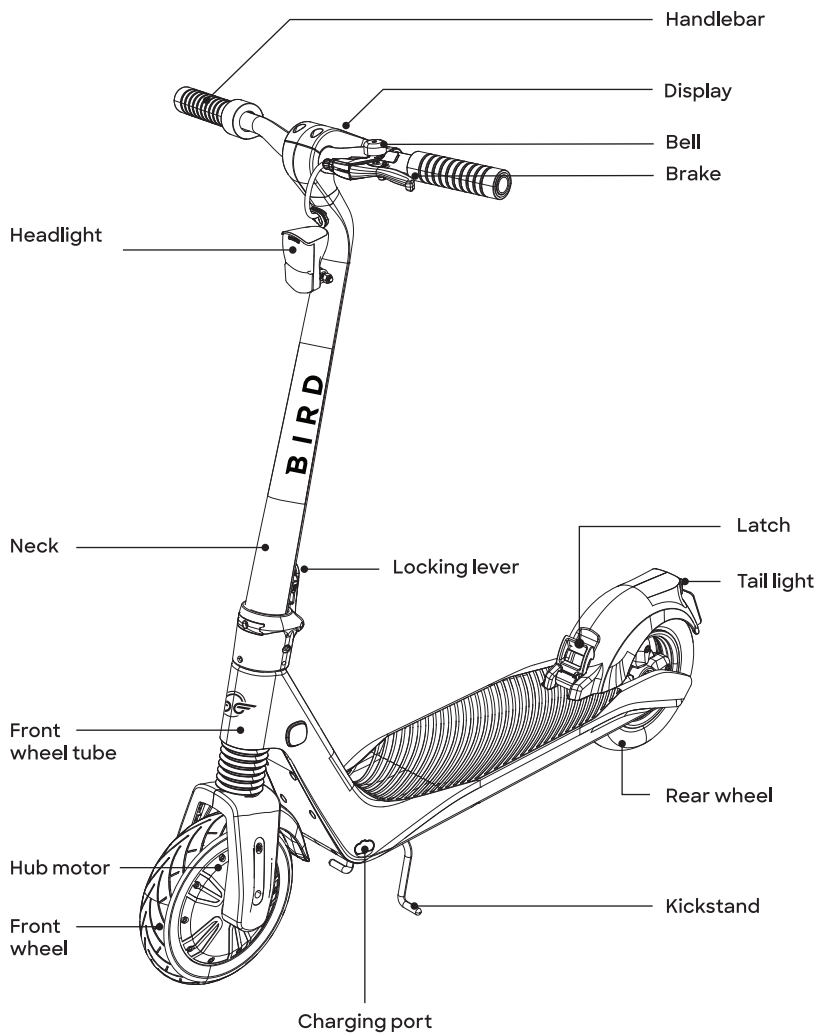

Assembly



Remove packaging and accessories

Remove the Bird Flex and all of the included accessories from the box.

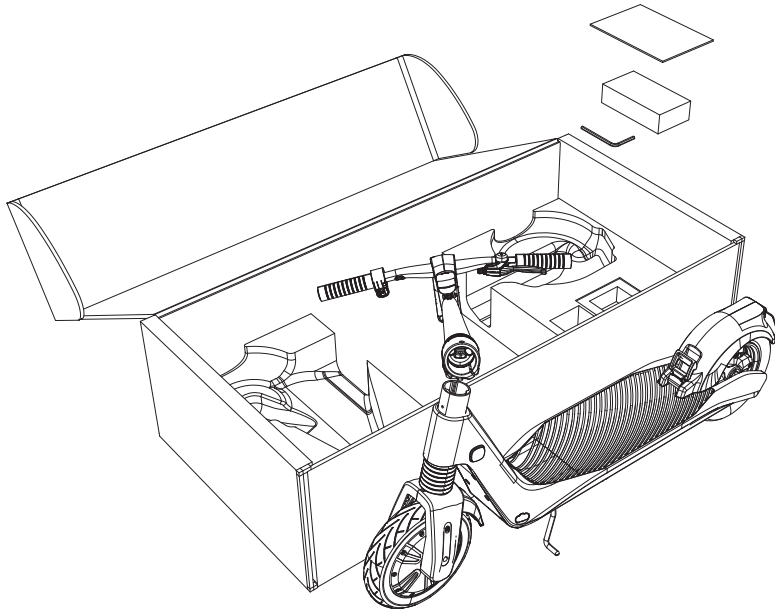
Also remove all packaging materials and use the kickstand to keep it standing upright as you install the neck and handlebar.



Assembly materials:

<p>ALLEN WRENCH</p>  <p>x 2</p>	<p>SCREWS (ALREADY ATTACHED, BUT NEED TO BE TIGHTENED)</p>  <p>x 3</p>	<p>CHARGER AND PLUG</p>  <p>x 1</p>
--	---	--

Assembly

Prep and align neck and handlebar

Using the allen wrench, remove the protective rubber piece that's wrapped around the front wheel tube so that the neck can be installed.

Then straighten the neck and line up the bottom of the collar with the top of the front wheel so that the front hole in the neck is lined up straight.

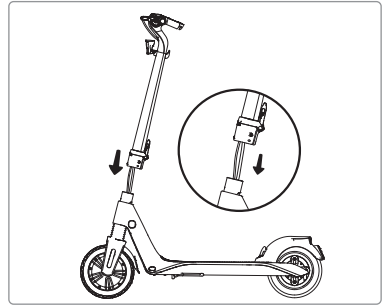
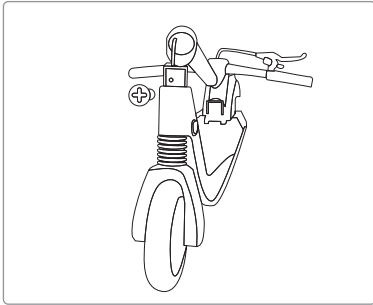

Attach neck to front wheel tube

There are 3 screws to tighten up, one in the front and two on the inside that will keep the neck in place and fully secured to the front wheel tube.

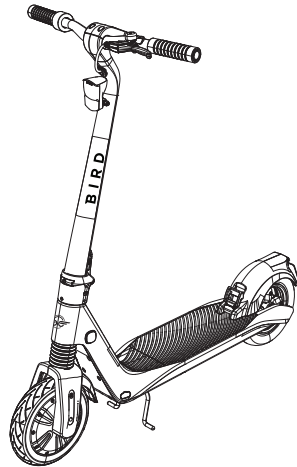
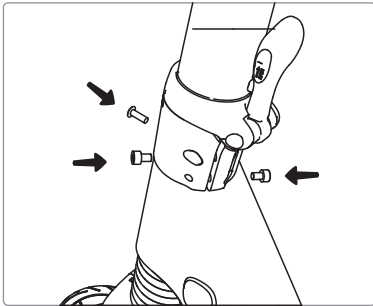

Charging

Connect the power adapter

Once you've assembled your Bird Flex, it's time to charge. Use the included power supply and connect it to the charging port.

When fully charged, a green light on the power supply indicates the charge is complete. Disconnect the power supply from the charging port before riding.

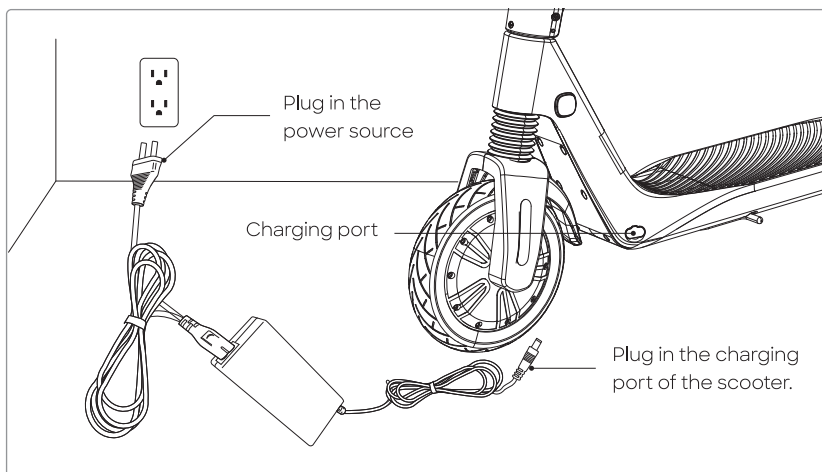

⚠ WARNING: Do not attempt to charge if the charging port or power adaptor is wet.

⚠ WARNING: Only use charger specified by the manufacturer.
MANUFACTURER: SHENZHEN FUYUANDIAN POWER CO LTD
MODEL: FY-4202000

⚠ WARNING: Ambient temperature must be 32-104°F (0-40°C) during charging. The battery will not charge outside of these temperature limits.

⚠ WARNING: Risk of Fire: Do not attempt to disassemble the charger. No user serviceable parts.

Riding

Power On

To turn the Bird Flex on or off, short press the Power button at the bottom of the dash display to turn it on, and hold down the power button for at least 3S to turn off.

Check Dash Display

The Bird Flex uses a dash display screen to show the speed (miles per hour or kilometers per hour) and battery charge level.

Turn on the headlight

Press the power button once to turn the headlight on and off.

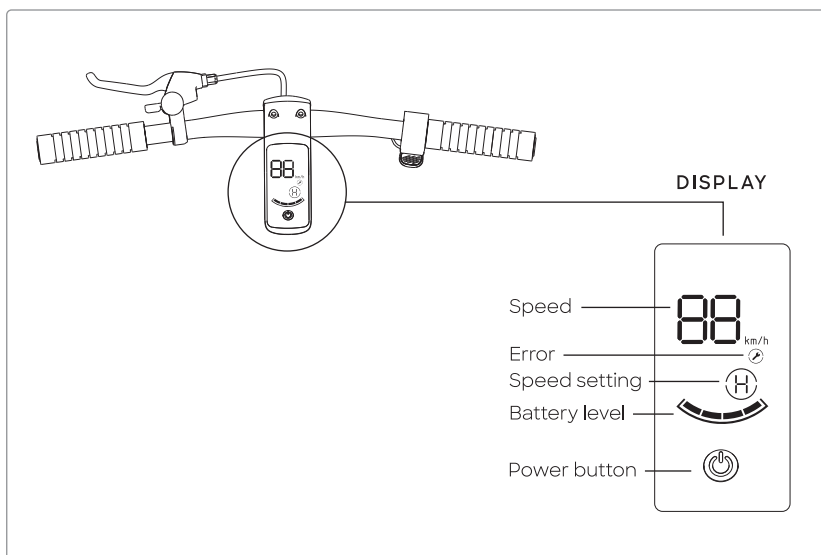

Riding

Starting

To start a ride, first, make sure to fold in the kickstand. Kick to start the Bird Flex by having one foot on the vehicle and one foot on the ground. Push the vehicle with at least two kicks before boarding it to ride.

Press the throttle (accelerator) down at the right handlebar to accelerate the scooter.

Stopping

Use the brake at the left handlebar to decelerate or stop the vehicle.

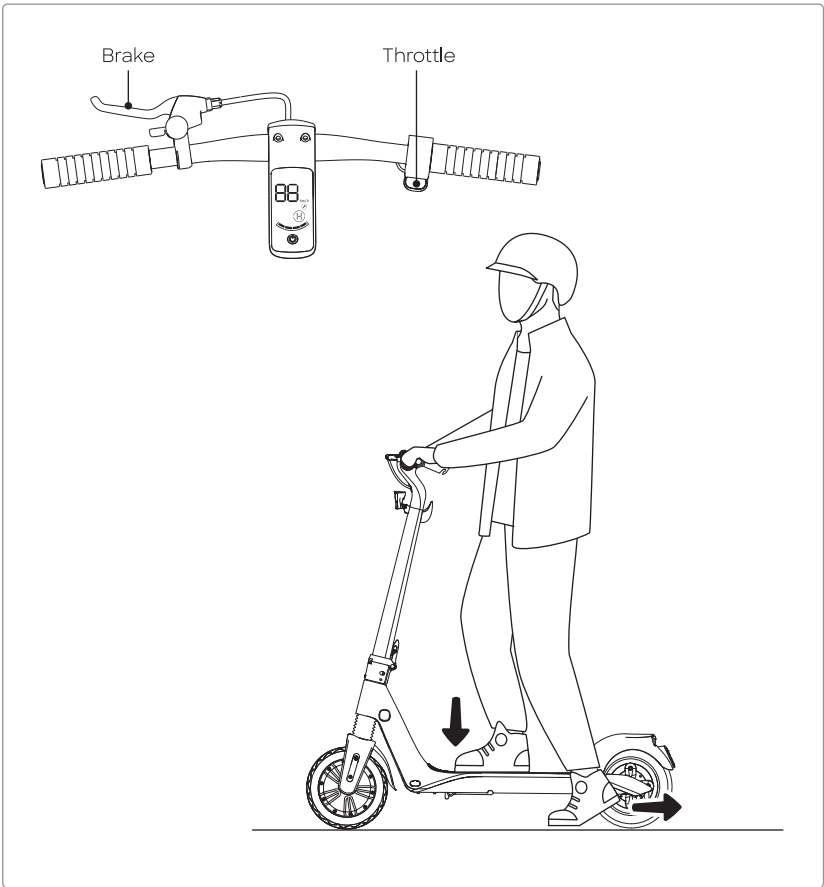

Folding

Releasing the latch

After pushing the slider up on the left side of the locking lever, pull the locking lever downward.

Folding down and locking the neck

Slowly fold down the neck until the underside of the display locks into place at the latch on the back of the foot board at the base of the back fender. It will snap into place after it's locked in and secured properly.

Be sure to lift up on the neck while locked before fully carrying the Bird Flex to ensure that the neck is properly locked into place.

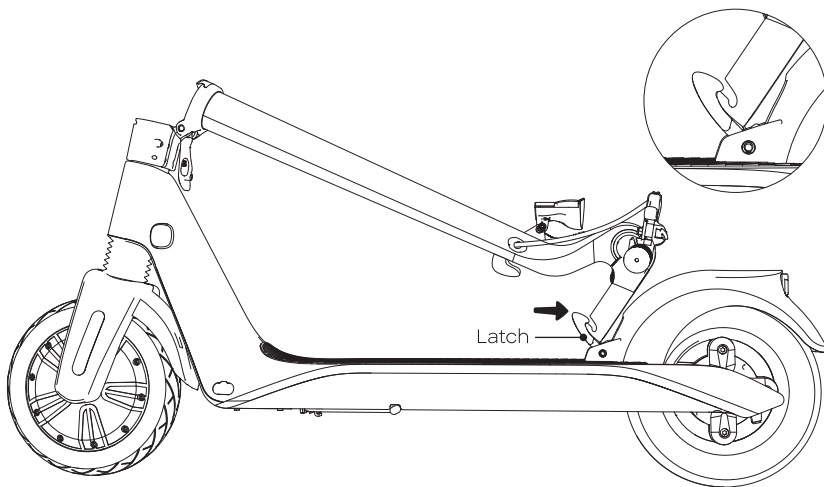
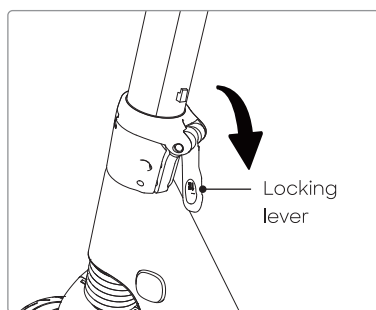
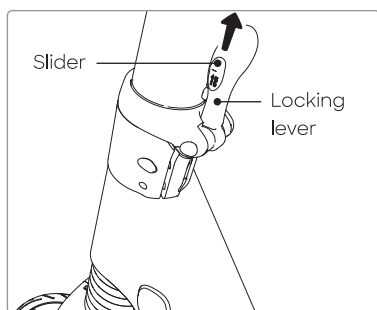

Unfolding

Unfolding the neck

To unfold the neck, release the top of the neck from the latch at the base of the back fender and straighten it all the way up until it's in place.

Once straightened, push up the locking lever until it's secured into place in the fully locked position. The latch is fully secured when it won't move down without first pressing up on the slider to release it.

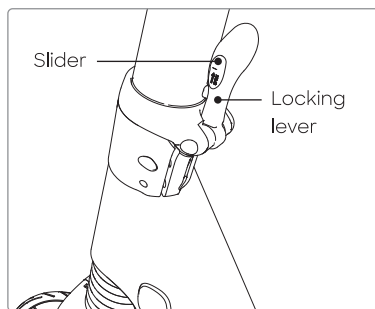
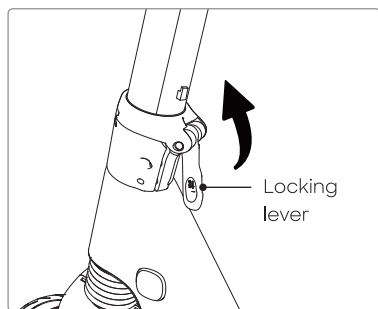
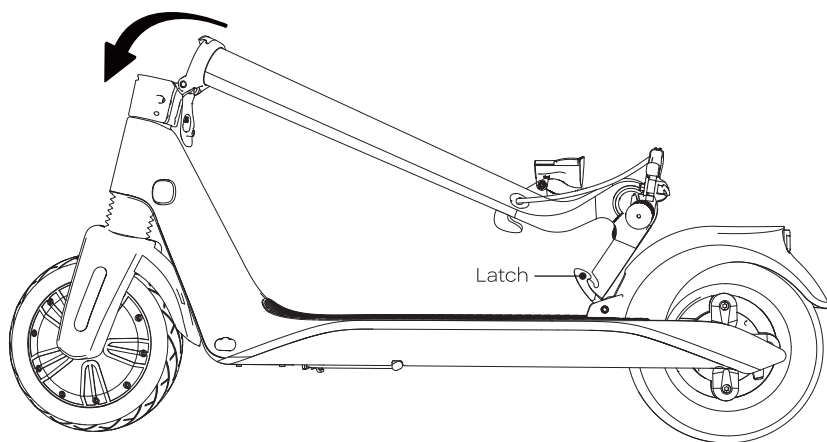

WARNING:

Failure to follow unfolding instructions could result in unintentional folding. Ensure that the latch is upright and locked in place.

Specifications

Battery	36V, 7.8Ah, 280.8Wh
Range	Up to 15.5 miles (25 km)
Charging	Fast charge port
Connectivity	Bluetooth
Splash Resistant	IPX4
Lights	Front LED, automatic rear LED
Braking	Lever for rear brake and regenerative braking
Wheels	9.5" (24 cm) front tire, 10" (25.4 cm) rear tire
Top Speed	18 mph (28 km/h)
Hill Grade	15% grade
Weight Limit	220 lb (100 kg)
Storage Temperature	14 -104°F (-10-40°C)
Operating Temperature	14 -104°F (-10-40°C)

Charger specifications

Input Voltage	100-240AC, Output Voltage = 42VDC, Output Current: 2.0 Amps, Charger Manufacturer: SHENZHEN FUYUANDIAN POWER CO LTD Model: FY-4202000 (Only Use Charger Provided)
Charging Temperature	32-104°F (0-40°C)

Dimensions

Length x Width x Height	44.3" x 23" x 45.9" (1125 mm x 585 mm x 1165 mm)
Weight	48.5 lbs (22 kg)

Error codes

ERROR	ERROR NAME	CAUSE	SOLUTION
01E	Overcurrent protection	The current from the battery to the controller is too high.	<ol style="list-style-type: none"> 1. Turn off the power, wait, and turn back on to see if the current is back to normal. 2. If error persists, contact support.
02E	Undervoltage protection	When the battery voltage is lower than 30.5V.	<ol style="list-style-type: none"> 1. Charge battery to 100% with charger included. 2. If error persists, contact support.
08E	Overheated motor	Motor temperature exceeds normal operating level.	<ol style="list-style-type: none"> 1. Stop riding and let the motor cool down. 2. If error persists, contact support.
09E	Handlebar connection failure	Handlebar functionality is having issues.	<ol style="list-style-type: none"> 1. Check the wiring to the handlebar. 2. Make sure the handlebar isn't cinching a cable. 3. If error persists, contact support.
10E	Brake lever failure	Brake lever connection has failed due to poor contact or other issue.	<ol style="list-style-type: none"> 1. Check the brake wiring and make sure everything is connected properly. 2. If error persists, contact support.
19E	Brake lever not returned properly	The brake lever isn't returned to its normal state when the Bird Flex is powered on.	<ol style="list-style-type: none"> 1. Return the brake lever to its starting position. 2. If error persists, contact support.
31E	Overheated controller	Controller temperature exceeds normal operating level.	<ol style="list-style-type: none"> 1. Stop riding and let the controller cool down. 2. If error persists, contact support.

Cleaning and storage

- Use a soft, wet cloth to wipe the mainframe clean. Hard to remove dirt can be scrubbed with a toothbrush, then cleaned with a soft wet cloth.
- Do not wash your Bird Flex with alcohol, gasoline, acetone, or other corrosive solvents. These substances may damage the appearance and internal structure of your Bird Flex. Do not wash your Bird Flex with a power washer or hose.
- Warning: Make sure your Bird Flex is powered OFF and the charging cable is unplugged before cleaning; otherwise you may damage the electronic components.
- Storage Temperatures: 14–104°F (-10–40°C)

Battery pack maintenance

- Do not store or charge the battery at temperatures outside of the stated limits (see specifications). Do not puncture the battery. Refer to your local laws and regulations regarding battery recycling and/or disposal.
- A well maintained battery can perform well even after many miles of riding. Charge the battery after each ride to avoid draining the battery completely. When used at room temperature (22 °C [70 °F]) the battery range and performance is best.
- Warning: Do not attempt to disassemble the battery. Risk of fire. No user serviceable parts.
- Warning: Do not ride when the ambient temperature is outside of the operation temperature (see specifications), because low/high temperature will limit the maximum power/torque. Doing so could cause personal injury or property damage due to slips or falls.



Questions? We've got answers.

Visit support.bird.co for help and warranty info.

1-888-309-3702 (M-F 9a-5p EST)

BirdFlex@bird.co

Bird Rides

406 Broadway Avenue #369

Santa Monica, CA 90401

Instructions and safety guidelines

- Before each use, conduct a basic safety inspection of the Bird Flex, including:
 - (i) trueness of the wheels & condition of tires;
 - (ii) safe operation of all brakes and lights;
 - (iii) good condition of the frame;
 - (iv) sufficient battery charge power; and
 - (v) any sign of damage, unusual or excessive wear, or other open and obvious mechanical problem/maintenance needs.
- Components shall be maintained and repaired in accordance with the manufacturer's specifications and using only the manufacturer's authorised replacement parts with installation performed by dealers or other skilled persons.
- Do not modify the scooter as it will void your warranty and introduce potential safety issues. Read and understand all safety warnings listed on the product label.
- Recommended age: 16+ years old.
- Maximum weight: 220 lb (100 kg). No more than one rider should ride at a time.
- Risk of injury or death from loss of control, collisions, and falls. Helmets and other protective equipment are highly recommended and may be required by law.
- Be sure to read the User Manual local to your region found on support.bird.co.
- Product warranty for your region can be found by visiting support.bird.co
- Comply with local laws and regulations when riding this product. Do not ride where prohibited.
- Ensure the intended area of operation is safe. Do not ride in the snow, in the rain, or on roads which are wet, muddy, icy, or that are slippery for any reason. Do not ride over obstacles. Avoid sharp bumps, drainage grates, and sudden surface changes.
- Avoid streets and surfaces with water, sand, gravel, dirt, leaves, and other debris.
- The scooter should not be used for racing, stunt riding, or other maneuvers.
- For best results in stopping and deceleration, always use the hand brake and try to avoid braking while traveling downhill or at full speed.
- Avoid contact with moving parts. Ensure hands, feet, hair, clothing, and other body parts stay clear of moving parts like the motor or front wheel.
- ALWAYS keep both hands on the handlebar when riding.
- You should not ride the Bird Flex:
 - if under the influence of alcohol or drugs,
 - if you have a heart condition, are pregnant, have head, back, or neck ailments which limit your ability to ride safely,
 - if you have any mental or physical conditions that may make you susceptible to injury or impair your physical dexterity or mental capabilities to recognise, understand, and perform all of the safety instructions and to be able to assume the hazards inherent with the Bird Flex.
- DO NOT attempt to disassemble the battery. Risk of fire.
- Never modify the electrical system as this may result in a risk of electric shock, electrocution, or fire.
- DO NOT attempt to charge a vehicle while wet.

- DO NOT ride or attempt to charge a vehicle that has been submerged in water or if there is risk of water intrusion into the battery compartment, even if the vehicle is no longer wet. Contact Bird for further instructions.
- To prevent electric shock when cleaning, remove the charger plug from the outlet and wipe vehicle with a dry cloth. Only use the charging cable provided by the manufacturer.
- Only store in dry areas. Never store in wet conditions.
- Devices are not intended for use at elevations greater than 2000 m above sea level.
- Prolonged Exposure to UV Rays, Rain and the Elements May Damage the Enclosure Materials, Store Indoors When Not in Use.

Federal Communications Commission (FCC) Compliance Statement for USA

This device complies with part 15 of the FCC rules. Operation is subject to the following two conditions:

- (1) This device may not cause harmful interference, and
- (2) this device must accept any interference received, including interference that may cause undesired operation.

Note: This equipment has been tested and found to comply with the limits for a Class B digital device, pursuant to part 15 of the FCC Rules. These limits are designed to provide reasonable protection against harmful interference in a residential installation. This equipment generates, uses, and can radiate radio frequency energy; if not installed and used in accordance with the instructions, it may cause harmful interference to radio communications. There is no guarantee that interference will not occur in a particular installation. If this equipment does cause harmful interference to radio or television reception, which can be determined by powering the equipment off and on, the user is encouraged to try to correct the interference by using any of the following measures:

- Reorienting or relocating the receiving antenna.
- Increasing the separation between the equipment and receiver.
- Connecting the equipment into an outlet on a circuit different from that to which the receiver is connected. Consult the dealer or an experienced radio/TV technician for help.

This equipment complies with FCC radiation exposure limits set forth for an uncontrolled environment.

Caution: Changes or modifications not expressly approved by the party responsible for compliance could void the user's authority to operate the equipment.

Disclosure for Users in the State of California

as required by CA Vehicle Code 407.5

**YOUR INSURANCE POLICIES MAY NOT PROVIDE
COVERAGE FOR ACCIDENTS INVOLVING THE USE
OF THIS SCOOTER. TO DETERMINE IF COVERAGE IS
PROVIDED, YOU SHOULD CONTACT YOUR
INSURANCE COMPANY OR AGENT.**

**YOU MAY NOT MODIFY OR ALTER THE EXHAUST SYSTEM OF
THIS SCOOTER CAUSE IT TO AMPLIFY OR CREATE EXCESSIVE
NOISE PER VEHICLE CODE SECTION 21226, OR TO FAIL TO
MEET APPLICABLE EMISSION REQUIREMENTS PER VEHICLE
CODE 27156.**



Bird and the Bird logo are registered trademarks of Bird Rides, Inc.